

Perilica-sušilica sa gornjim punjenjem WDT 5431

Uputstvo za upotrebu

Blomberg

Programming

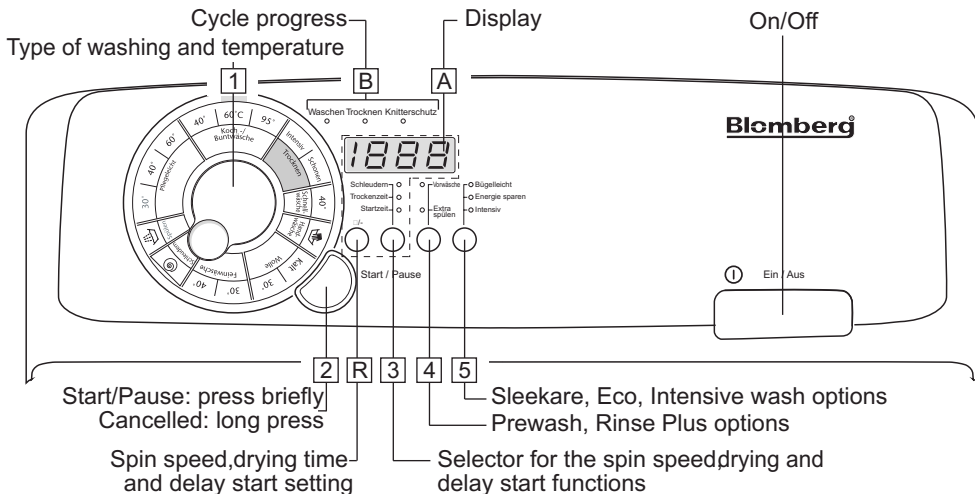

Start/Pause: press briefly
Cancelled: long press

Spin speed, drying time
and delay start setting

Sleekare, Eco, Intensive wash options
Prewash, Rinse Plus options

Selector for the spin speed/drying and
delay start functions

Apart from the «On/Off» button (Ein/Aus), all the buttons are sensitive and therefore do not remain depressed.

During programming, all the buttons except for «Start/Pause» can be kept depressed but, for more precise adjustment, we recommend that you operate them with a series of brief presses.

You should operate the «Start/Pause» by pressing it briefly except when cancelling the programme, in which case it should be kept depressed.

(*) Details of the function are provided in the following pages.

If one of the cycle progress lights **B** is lit when you switch on, cancel before carrying out any other operation.

Warning: the «On/Off» button cannot cancel a programme.

Full programming (combined with drying or not)

	Lights and/or display
• Press in the «On/Off» button (Ein/Aus) (1).	
• Turn the selector 1 to select the programme and the washing temperature. The machine proposes the recommended spin speed for the type of textile selected.	Light «Schleudern» + spin speed recommended on A
• Use the setting button R : - Either to alter the proposed spin speed. - Or to select stopping with the drum full of water. The machine will stop with the drum full of water before the final spin.	Light «Schleudern» + e.g.: 800 or 1888
• Select, or not, any of the following options: - «Prewash» (Vorwäsche) and/or «Rinse Plus» (Extra Spülen) via button 3 - «Sleekare» (Bügelleicht) and/or «ECO» (Energie sparen) and «Intensive» (Intensiv) via button 4 - Subsequent immediate drying via button 5 then, via button 6 , set the desired drying time (for the washing load to be dried, see the Programmes table)	+ selected options + «Trockenzeit» + e.g. 1.35
• Select immediate start by pressing the «Start/Pause» button 2 ...	Light «Waschen» + display of washing time remaining A
• ... Or select a start delayed by 1 - 19 hours by using button 5 to select this option (Startzeit) and then using button R to set the period of the delay.	Light «Startzeit» + display of time remaining before the cycle starts A

Full programming (continued):

Lights and/or display

After spinning, the machine positions the drum automatically with the opening at the top to help you in removing your laundry. This operation takes 3 minutes at most.

18:08

- Then the message «0» appears on the display, indicating the end of the cycle (2).
Wait a moment of two for the lid to unlock so that you can remove your laundry. Release the «On/Off» button (Ein/Aus) (3).

Programming a Drying Only cycle:

- Press in the «On/Off» button (Ein/Aus).
- Turn the selector [1] to select a normal (Intensiv Trocknen) or mixed (Schonen Trocknen) drying programme to suit your type of washing.
- Select the «Sleekare» option (Bügelleicht), or not, via button [5]. This option finishes your programme with a 2 hour «Resting» period (see Function Details)
- Set the desired time via button [R] (only dry washing that has been spun at least at 800 rpm)
- Select immediate start by pressing the «Start/Pause» button [On] ...
- ... Or select a start delayed by 1 - 19 hours by using button [On] to select this option and then using button [R] to set the period of

Light «Trockenzeit» and selected option

+ e. g. 18:35

Light «Trocken» + countdown of the remaining cycle time on [A]
or display of time remaining before the cycle starts [A]

Adding or removing an item during the cycle (impossible during spin):

- Press the «Start/Pause» button [2] to interrupt the cycle.
- Add or remove the items of laundry.
- Press the «Start/Pause» button [2] to restart the cycle.
(* The lid may take 1-2 minutes to unlock
If you have selected a «Delay Start», you can instantaneously access the drum at any time during the phase before the washing cycle starts, without having to interrupt and restart the cycle.

Flashing light [B]
+ counter [A] stopped
Light [B] permanently lit
+ counter [A] restarts

Cancelling during programming or washing or during a pause:

- Hold down the «Start/Pause» button [2] for at least 1 second. This can be done at any time during the cycle or during programming, or even during a pause.
If you do this while the machine is waiting to start during a delay start, only the delay start is cancelled.

Return to initial display

Maintaining your washing machine's performance:

- At the end of the cycle, you must clean the dryer filter (see the Chapter on "RUNNING MAINTENANCE").
~~For more information, please refer to the section on «DETAILS OF THE FUNCTIONS».~~

Important: If you have stopped your machine by pressing the «On/Off» button (Ein/Aus) or after a power failure, when the power is restored the washing cycle automatically returns to the point at which it was interrupted.

- (1) - Before starting your machine, check that the power cable is plugged in and the water tap is open. Also ensure that the drum doors and the lid are firmly closed.
- (2) - During the «end of cycle» phase, the machine will not recognize your pressing one of the [2], [3], [4], [5] or [R] buttons but does allow you to return to «programming» mode.
- (3) - As a safety measure, it is advisable to unplug the power cable and turn off the water tap.

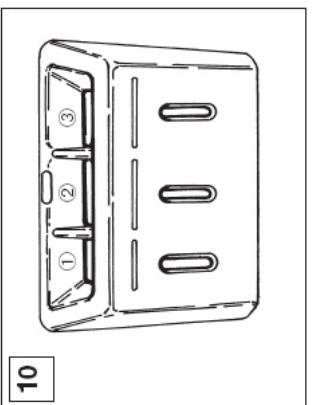
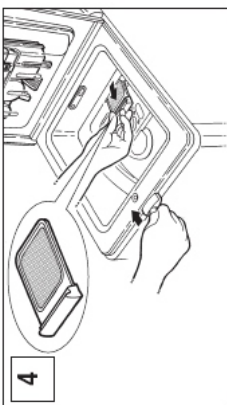
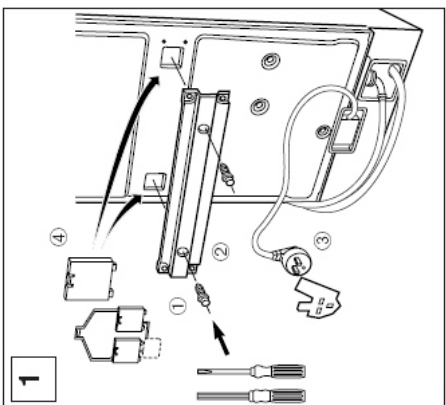
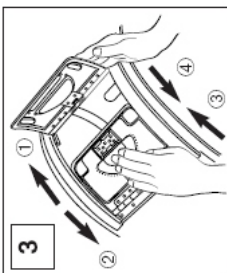
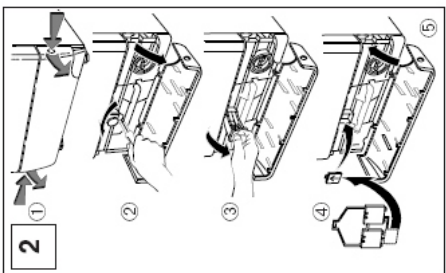
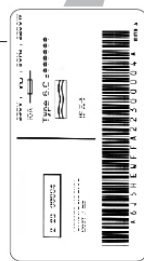
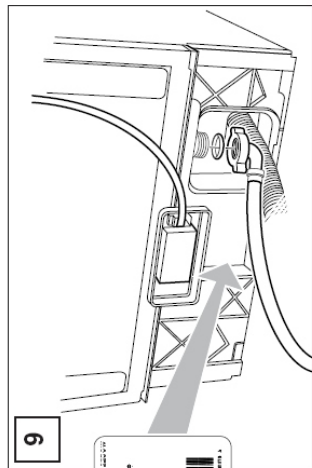
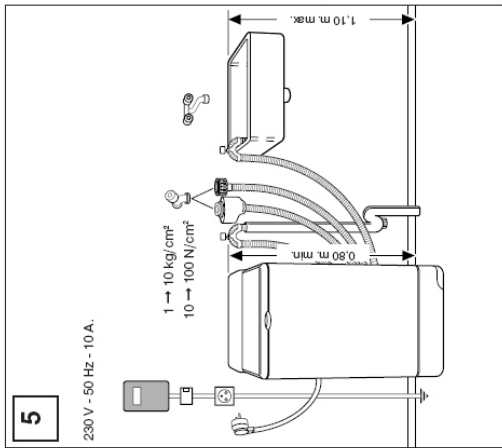
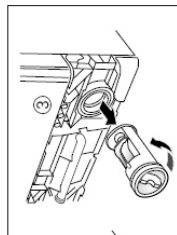
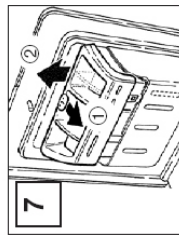
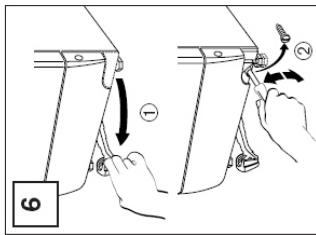

Programming

To select the most suitable programme for your type of washing, follow the instructions on the labels attached to most items.

Programmes table	Temperature (°C) Kalt = Cold	Max. load (kg)	Vorwäsche	Extra spülen	Bügelleicht	Energie sparen	Intensiv	1 1 1 1	Drying : Normal(Intensiv) or Mixed (Schonen)	Type of drying and drying time				
			Prewash	Rinse Plus	Sleekare	Eco	Intensive	Rinse hold		Max. load (kg)	very dry	dry	iron dry	
COTTON /WHITES (Koch-/Buntwäsche)	40°-95°	5	•	•	•	•	•	•	Inten.	2.5	1 1/4 to 1 3/4 h	1 to 1 1/2 h	30min to 1h	
COLOURS/SYNTHETICS (Pflegeteicht)	30°-60°	2.5	•	•	•	•	•	•	Scho.	2.5	1 to 1 1/2 h	45min to 1h	30min to 45min	
DELICATE (Feinwäsche)	30°-40°	2		•	•				Scho.	1	45min to 1h	30min	30min to 45min	
WOOL (Wolle)	Kalt-30°	1.5		•							Cannot be machine dried			
HAND WASH (Handwäsche)	Kalt	1		•							Cannot be machine dried			
Special programmes														
EXPRESS (Schnellwäsche)	40°	2.5							•		Cannot be machine dried			
RINSE (Spülen)		Depending on the textile							•		Cannot be machine dried			
SPIN (Schleudern)			Before drying, select the "Maximum" speed the washing can withstand.											
Intensiv Trocknen	Normal Drying Only								COTTON / WHITES / COLOURS		See above to select the load, drying time and type of drying for your type of textiles			
Schonen Trocknen	Mixed Drying Only								SYNTHETICS / DELICATE					

- : These functions can be used alone or in combination. Logical combinations are impossible.

Details of the functions

COTTON /WHITES (Koch-/ Buntwäsche)
If your washing comprises hard-wearing white or coloured COTTONS

When washing coloureds do not exceed a maximum temperature of 60°C.
During the first few minutes of this programme, your machine automatically calculates the best programme to run for a perfect wash.

COLOURS /SYNTHETICS (Pflegeteicht)
If your washing comprises DELICATE COLOURS, HARD-WEARING SYNTHETICS or MIXED FIBRES

DELICATE (Feinwäsche)
If your washing comprises NET CURTAINS, DELICATE FABRICS or FRAGILE TEXTILES

WOOL (Wolle)
If your washing comprises WOOLLENS or MACHINE-WASHABLE WOOLLENS.

HAND WASH (Handwäsche)
If your washing comprises SILK or PARTICULARLY DELICATE FABRICS

EXPRESS (Schnellwäsche)
This programme enables you to refresh a small load of 2.5 kg of lightly soiled washing composed of WHITE or COLOURED COTTONS or HARD-WEARING SYNTHETICS. The cycle time is restricted to around 30 minutes.

In this programme, the washing temperature is automatically programmed to 40°C.

For this programme, the doses of detergent should be reduced by half.

Details of the functions (continued)

RINSE ONLY (Spülen)

A separate rinse followed by a choice of:

- Either spin and drain
- Or a stop with the drum full of water.

SPIN ONLY (Schleudern)

This allows a separate spin and drain.

In the case of «Rinse only» followed by a spin or of «Spin only», take care to select a suitable spin speed for the type of washing in the machine.

Details of the options

PREWASH (Vorwäsche)

Specially designed for heavily soiled washing (mud, blood, etc.).

Detergent must be placed in the «I» container in the products' box.

RINSE PLUS (Extra spülen)

«Especially for sensitive and allergic skin»: adds a Rinse Plus to the washing cycle.

SLEEKARE (Bügelleicht)

Makes your washing easier to iron.

This option allows you to wash and spin your washing more gently without any loss of performance.

ECO (Energie sparen)

The «Eco» function provides you with perfect washing results while saving on energy. It reduces the washing temperature and increases the agitation period.

INTENSIVE WASH (Intensiv)

This function improves washing performance and handles reputedly stubborn stains by automatically increasing the temperature in the drum and the agitation time.

Resting period at the end of the drying cycle

To use this function, you must first programme the «Sleekare» option.

Your laundry will rest for 2 hours after the drying cycle is complete. The «Knitterschutz» light remains lit throughout the resting period.

To access your laundry during this period, cancel the option by pressing the «Start/Pause» button [2] for at least one second.

Delay start (Startzeit)

You can delay the start of your programme by 1 to 19 hours to take advantage of off-peak rates or finish the cycle at a particular time.

To do this, press button [3] and select function «Delay start» (Startzeit). Then press button [R] and select the cycle starting time.

While the machine is waiting to start, display [A] shows the time remaining before the cycle effectively starts.

Remaining time (Restzeit)

During programming, pressing button [3] until the 3 lights go out lets you know the length of the selected cycle*.

If you select the «time remaining» function while the machine is waiting to start in «Delay Start» mode, it is the selected programme's time that is permanently displayed.

(*) The time indicated by the machine at the start of the programme may vary during the course of the cycle:

- If you change the washing temperature (even during a spin) or if you add or cancel options, the time will be recalculated and updated on the display.
- Certain operating variables (for instance: detection of imbalance or foam, etc.) can also alter the cycle's duration.
- If there is a power failure during washing, when the power is restored, the time displayed may be less than the actual remaining time. This time will be updated at the start of the rinsing phase.

Rinse hold

This is used for textiles that you do not wish to spin or if you envisage being absent for a long time after the washing is finished.

When this function is selected, the cycle interrupts before the final spin, enabling your washing to soak in the water to avoid creasing.

When the machine stops with the drum full of water, display [A] does not count off the time remaining but remains fixed (including the point).

Then:

- You either wish to drain and spin. In which case, select the Spin function (Schleudern) using button [3] then use button [R] to set a suitable spin speed for your type of washing. The programme will shut down automatically.
- Or you just wish to drain. In which case, select the Spin function (Schleudern) and then use button [R] to display [1000].

Modifying a washing or drying programme

During programming:

You can alter anything before you press the «Start / Pause» button [2] .

After the cycle starts:

- You cannot alter the type of textile (for example, change from «COTTON» to «SYNTHETICS» or from «SYNTHETICS» to «DELICATES», etc.).

If you turn the programme selector [1] to a different textile, the progress cycle light [B] which is lit at the time, and the display [A] flash for a few seconds to indicate that such an alteration is prohibited and will not be effected.

To change the type of fabric during the cycle, you must cancel the current programme and then programme a new cycle.

- However, you can change the washing temperature at the start of the washing phase for the same type of textile.

The time remaining will then be adjusted accordingly.

- You can also change the spin speed throughout the cycle.
- You can select «Rinse hold» up to the end of rinsing.
- You can change the period for a «delay start» period throughout the whole of the waiting period, right up to the effective cycle starting time.

If you wish to cancel «Delay start» during this period, set display [A] to «0» and then briefly press button [2] .

The cycle will then start immediately.

- You can only activate option «Prewash» (Vorwäsche) during the waiting period for a «Delay start».
- You can activate option «Rinse Plus» (Extra spülen) up to the point that rinsing commences.
- You can only modify the options «Sleekare» (Bügelleicht), «Eco» (Energie sparen) and «Intensive» (Intensiv) during the waiting period for a «Delay start».
- You can deactivate all the options at any time during the cycle provided that the particular action has not already been completed.
- You cannot programme or modify a drying after the start of a washing or drying cycle.

At the end of the cycle:

When your display shows «0-», you can programme a new cycle without releasing the «On/Off» button (Ein/Aus).

All you need to do is press any of the buttons [2], [3], [4], [5] or [R].

The machine is then ready for programming again.

Automatic safety systems

Lid opening safety system:

As soon as washing commences, the lid on your machine is locked.

When the cycle is finished or when the machine has stopped with the drum full of water, the lid unlocks.

If you have programmed a «Delay start», the lid is not locked until the waiting period is over and the cycle starts.

If you wish to open the lid during the cycle, press button [2] briefly and wait 1-2 minutes for the safety system to unlock the lid.

Water safety system:

The water is constantly controlled when the machine is operating to prevent any possible overflow.

Spin safety system:

Your washing machine is fitted with a safety system that restricts the spin when poor load distribution is detected.

In this case, your washing may be insufficiently spun. Redistribute your washing in the drum and programme a new spin.

Anti-foam system:

Your machine can detect when too much foam is being produced during spinning.

At such times, spinning stops and the machine drains.

The cycle then restarts, adapting the spin rates and possibly adding an extra rinse.

Programmes for energy labelling tests - Characteristics

Washing: Cotton - 60°C – 5Kg – no options – max. spin.

Drying: Cotton - Very dry - 2,5 kg

Characteristics: 230V – 50Hz – 10A – 2200W.

«Filt» message:

(only for washing machines)

After a certain number of cycles, your machine (depending on the model) will warn you that you should clean the pump filter.

At the end of the cycle, the display  flashes and then shows:



This information disappears as soon as you programme a new washing cycle or when the «On/Off» button (Ein/Aus) is released.

If you do not clean the pump filter regularly, this will affect your machine's performance.

Cleaning the pump filter:

(for washing machines AND washer-dryers)

First of all drain the machine and then disconnect the plug (FIG. 8)

- Remove the plinth and place a floor cloth and a flat container under the access to the pump.
- If your machine is fitted with one, remove the purge hose.
- Open the stopper at the end of the hose and let the water flow into the container.
- Close the stopper, ensuring that it is pushed in well and reclip it in place.
- Unscrew the stopper for the drain pump's filter.
- Clean the filter. To re-insert it, snap it in by orienting the small lug on the cylindrical surface upwards and screwing the stopper in fully.
- Re-install the plinth in its original position.

When you next wash, check that there are no leaks during filling.

Cleaning the machine

- Only use a sponge, liquid soap and water to clean the casing, the entry to the drum, the control panel and the products' box, etc.
- Never use: abrasive powders, metal or plastic sponges, alcohol-based products, thinners, etc.

Cleaning the detergent dispensers

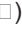
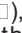
- Pull the knob forward (FIG. 7 ) and lift the dispensers out (FIG. 7 )
- Clean everything with warm water, not forgetting to wash the removable siphon (blue). Check that you have replaced it correctly.
- Then re-insert the whole dispensers, checking that they are positioned correctly.

Replacing the power cable: For the sake of your safety, this must necessarily be done by the manufacturer's After-Sales service or a qualified electrician.

Regularly check: The condition of the water supply and drain hoses. If you notice the slightest cracking, do not hesitate to replace them.

Replacing the water supply hose (FIG. 9): When changing, check that the hose is tight and that there is a seal on both ends.

When there is a risk of frost: Drain the drain circuit as shown above.

Removing the drum's paddle:

If an item of washing falls between the drum and the side of the tub, empty the drum and close it.

- Turn the drum until the paddle locks.
- Unscrew the screw between the two openings (stamped TORX. T20) and remove it. The paddle will fall into the drum (use a terry towelling towel to cushion its fall as a precaution).
- Turn the drum back and open it.
- Recover the fallen item through the holes revealed by removing the paddle.
- To refit the paddle, slip it from front to back over its support.
- Close the drum and turn it. Hold the paddle while you re-insert the screw.

Cleaning the drying filter:

(only for washer-dryers)

Clean this after every drying operation:

- Remove the filter from its housing (on the right, near to the opening for the drum) and pull it towards you (FIG. 4)
- Clean it dry, removing any fluff it may have caught.
- Replace it in its housing, pushing it in fully.